

THIS COPY IS PROVIDED ON A RESTRICTED BASIS AND IS NOT TO BE USED IN ANY WAY DETRIMENTAL TO THE INTERESTS OF PANDUIT CORP.

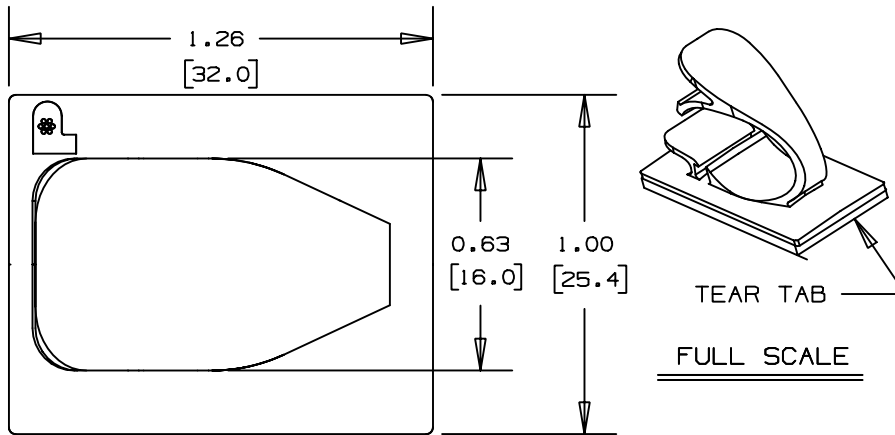

PANDUIT PART NUMBER*	MAXIMUM CABLE DIA. in. (mm)	WEIGHT lbs. (g)/100pcs
LWC50-A	0.50 (12.7)	0.84 (379)

NOTES:  
\*1) SEE CURRENT PRICE SHEET FOR PART NUMBER SUFFIX DESIGNATION, FOR PACKAGE SIZE.

2) MOUNT IS DESIGNED TO SUPPORT 0.63 lbs [284g] MAX WEIGHT ON A CLEAN DRY SMOOTH SURFACE.

TO APPLY LATCHING WIRE CLIP:  
1. REMOVE PROTECTIVE LINER  
2. PLACE IN DESIRED LOCATION  
3. APPLY PRESSURE TO TOP OF LATCHING WIRE CLIP

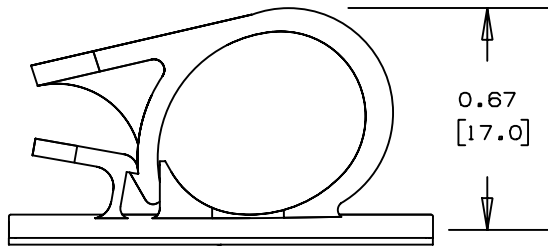

NO WARRANTY, EXPRESSED OR IMPLIED, IS MADE BY PANDUIT WITH RESPECT TO ADHESIVE BOND PERFORMANCE, AMONG OTHER THINGS, THE CONDITIONS UNDER WHICH THESE MOUNTS MAY BE APPLIED, AND/OR THE SURFACE TO WHICH THEY MAY BE APPLIED, ARE BEYOND PANDUIT'S CONTROL.

ADHESIVE BACKING: PRESSURE SENSITIVE FOAM 0.04 [1.0] THICK WITH PROTECTIVE LINER TO EXTEND BEYOND EDGE FORMING A TEAR TAB.

DIMENSIONS IN BRACKETS ARE METRIC [ mm ]

CAD FILENAME/LAYERS

GB0161BA\_PB\_LWC50A\_02

**PANDUIT**

CORP.

TINLEY PARK, ILLINOIS

LWC50-A, LATCHING WIRE CLIP

UNLESS OTHERWISE SPECIFIED,  
DIMENSIONAL TOLERANCES ARE:  
(.X) ±0.05 (1.3) (.XXX) ±0.010 (0.25)  
(.XX) ±0.02 (0.5) ANGLES ± 5°

UNLESS OTHERWISE SPECIFIED,  
ALL DIMENSIONS ARE GIVEN  
IN INCHES, THIRD ANGLE PROJECTION.

REV	DATE	BY	CHK	DESCRIPTION	ECN	R	CUST	SUP
2	11-10-00	CGSM		CORRECTED 0.67 DIMENSION PLACEMENT	GB0161BA	2		
1	1-7-98	CGSM		CHANGED NOTE 3 ON APPLICATION INSTR.	GB0161BA	1		
R	11-5-93	JRL		INITIAL RELEASE	GB0161BA	R		

DRAWN BY

JRL

MAT'L:

NYLON 6/6

DATE

11-5-93

CR'D

SCALE

2X

DRAWING NO.

GB0161BA

DWG

A  
SIZE